

NOTES:

- FOR STANDARD DOBA NOTES REFER TO DRAWING 2334-DOB-XX-SI-DR-S-0001 & S-0002
- REFER TO ARCHITECTS DRAWINGS FOR ALL SITE & APPLICATION BOUNDARIES
- THIS DRAWING IS TO BE READ IN CONJUNCTION WITH ALL OTHER RELEVANT ARCHITECTS & ENGINEER'S DRAWINGS AND SPECIFICATIONS
- USE FIGURED DIMENSIONS ONLY. DO NOT SCALE
- REFER TO SURVEY DRAWINGS FOR EXISTING SERVICES LAYOUTS AND MANHOLE INFORMATION
- ALL EXISTING SURFACES TO BE REINSTATED FOLLOWING DIVERSION OF SERVICES/CONSTRUCTION OF NEW SERVICES
- THE CONTRACTOR SHALL VERIFY ALL DIMENSIONS AND LEVELS WITH ARCHITECTURAL DRAWINGS PRIOR TO START OF CONSTRUCTION. ANY DISCREPANCIES TO BE NOTIFIED TO THE ENGINEER & ARCHITECT FOR RESOLUTION
- CONTRACTOR TO ENSURE ALL WATER & WASTEWATER RELATED WORKS ARE IN ACCORDANCE WITH THE RISH WATER WATER INFRASTRUCTURE & WASTEWATER INFRASTRUCTURE CODE OF PRACTICE & STANDARD DETAILS DOCUMENTS
- TESTING OF ALL GRAVITY SEWERS AND MANHOLES TO BE IN ACCORDANCE WITH RISH WATER CODE OF PRACTICE FOR WASTEWATER INFRASTRUCTURE SECTION 4.10 TESTING OF GRAVITY SEWERS & MANHOLES

MAINTENANCE REQUIREMENTS FOR BIORETENTION SYSTEMS & TREE PIT

REGULAR INSPECTIONS
INSPECT INFILTRATION SURFACES FOR SILTING AND PONDING. RECORD DE-WATERING TIME OF THE FACILITY AND ASSESS STANDING WATER LEVELS IN UNDERDRAIN (IF APPROPRIATE) TO DETERMINE IF MAINTENANCE IS NECESSARY. FREQUENCY - QUARTERLY
CHECK OPERATION OF UNDERDRAINS BY INSPECTION OF FLOWS AFTER RAIN. FREQUENCY - ANNUALLY
ASSESS PLANTS FOR DISEASE INFECTION, POOR GROWTH, INVASIVE SPECIES ETC AND REPLACE AS NECESSARY. FREQUENCY - QUARTERLY
INSPECT INLETS AND OUTLETS FOR BLOCKAGE. FREQUENCY - QUARTERLY

REGULAR MAINTENANCE
REMOVE LITTER AND SURFACE DEBRIS AND WEEDS. FREQUENCY - QUARTERLY (OR MORE FREQUENTLY FOR TIDINESS OR AESTHETIC REASONS)
REPLACE ANY PLANTS, TO MAINTAIN PLANTING DENSITY. FREQUENCY - AS REQUIRED
REMOVE SEDIMENT, LITTER AND DEBRIS BUILD-UP FROM AROUND INLETS OR FROM FOREBAYS. FREQUENCY - QUARTERS 1 TO BIANNUALLY
INFILL ANY HOLES OR SCOUR IN THE FILTER MEDIUM. IMPROVE EROSION PROTECTION IF REQUIRED. FREQUENCY - AS REQUIRED
REPAIR MINOR ACCUMULATIONS OF SLT BY RAKING AWAY SURFACE MULCH, SCARIFYING SURFACE OF MEDIUM AND REPLACING MULCH. FREQUENCY - AS REQUIRED

REMEDIAL ACTIONS
REMOVE AND REPLACE FILTER MEDIUM AND VEGETATION ABOVE. FREQUENCY - AS REQUIRED BUT LIKELY TO BE > 20 YEARS

ROOTSPACE SUPPORT STRUCTURE UNDER COVERED / GRILLED TREE PIT.

IN ALL COVERED COVERED / GRILLED TREE PIT AND IN ALL INSTANCES WHERE THE TREE PIT SOIL EXTENDS BENEATH THE FOOTPATH / PAVEMENT, A PROPRIETARY ROOTSPACE PAVEMENT SUPPORT SYSTEM BY GREENLEAF IRELAND, OR EQUAL APPROVED, SHALL BE INTEGRATED ACROSS THE FULL EXTENT OF THE TREE PIT. REFER TO LANDSCAPE ARCHITECT'S DRAWING FOR TREE PIT SOIL EXTENTS.

NOTES:

- NON-WOVEN GEOTEXTILE SPECIFICATION. THE GEOTEXTILE SHALL:
- SUSTAIN A TENSILE LOAD OF NOT LESS THAN 5.0kN/m AT BREAK AND HAVE A MINIMUM FAILURE STRAIN OF 10%
- WHEN DETERMINED IN ACCORDANCE WITH IS EN ISO 10319;
- HAVE A MINIMUM PUNCTURE RESISTANCE OF 1200 N WHEN DETERMINED IN ACCORDANCE WITH IS EN ISO 12236;
- HAVE A SIZE DISTRIBUTION OF PORE OPENINGS SUCH THAT THE APPARENT OPENING SIZE 090 WHEN DETERMINED IN ACCORDANCE WITH IS EN ISO 12956, OR OTHER APPROPRIATE TEST, IS LESS THAN 300 MICRONS
- ALLOW WATER TO FLOW THROUGH IT, IN EITHER DIRECTION, NORMAL TO ITS PRINCIPAL PLANE AT A RATE OF NOT LESS THAN 10 l/m² UNDER A CONSTANT HEAD OF WATER OF 100mm AND A MAXIMUM BREAKTHROUGH HEAD OF 50MM WHEN DETERMINED IN ACCORDANCE WITH IS EN ISO 12958.
- PLAN AREA OF THE BIO-RETENTION AREA SHOULD BE 2-4% OF THE OVERALL AREA DRAINED. MAXIMUM WIDTH 10m UNLESS NOTED OTHERWISE.

NON-WOVEN GEOTEXTILE SPECIFICATION. THE GEOTEXTILE SHALL:
- SUSTAIN A TENSILE LOAD OF NOT LESS THAN 5.0kN/m AT BREAK AND HAVE A MINIMUM FAILURE STRAIN OF 10%
- WHEN DETERMINED IN ACCORDANCE WITH IS EN ISO 10319;
- HAVE A MINIMUM PUNCTURE RESISTANCE OF 1200 N WHEN DETERMINED IN ACCORDANCE WITH IS EN ISO 12236;
- HAVE A SIZE DISTRIBUTION OF PORE OPENINGS SUCH THAT THE APPARENT OPENING SIZE 090 WHEN DETERMINED IN ACCORDANCE WITH IS EN ISO 12956, OR OTHER APPROPRIATE TEST, IS LESS THAN 300 MICRONS
- ALLOW WATER TO FLOW THROUGH IT, IN EITHER DIRECTION, NORMAL TO ITS PRINCIPAL PLANE AT A RATE OF NOT LESS THAN 10 l/m² UNDER A CONSTANT HEAD OF WATER OF 100mm AND A MAXIMUM BREAKTHROUGH HEAD OF 50MM WHEN DETERMINED IN ACCORDANCE WITH IS EN ISO 12958.

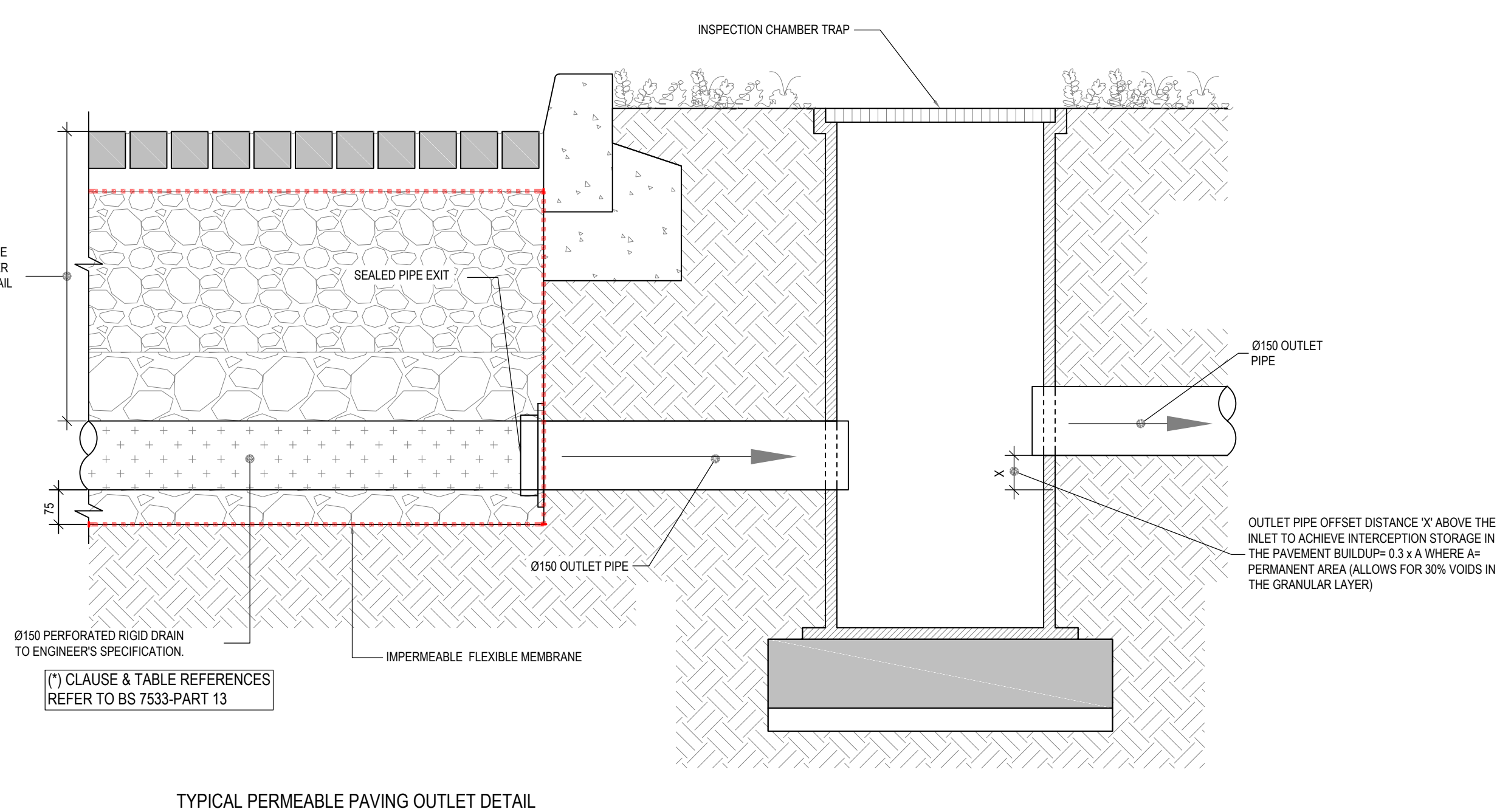
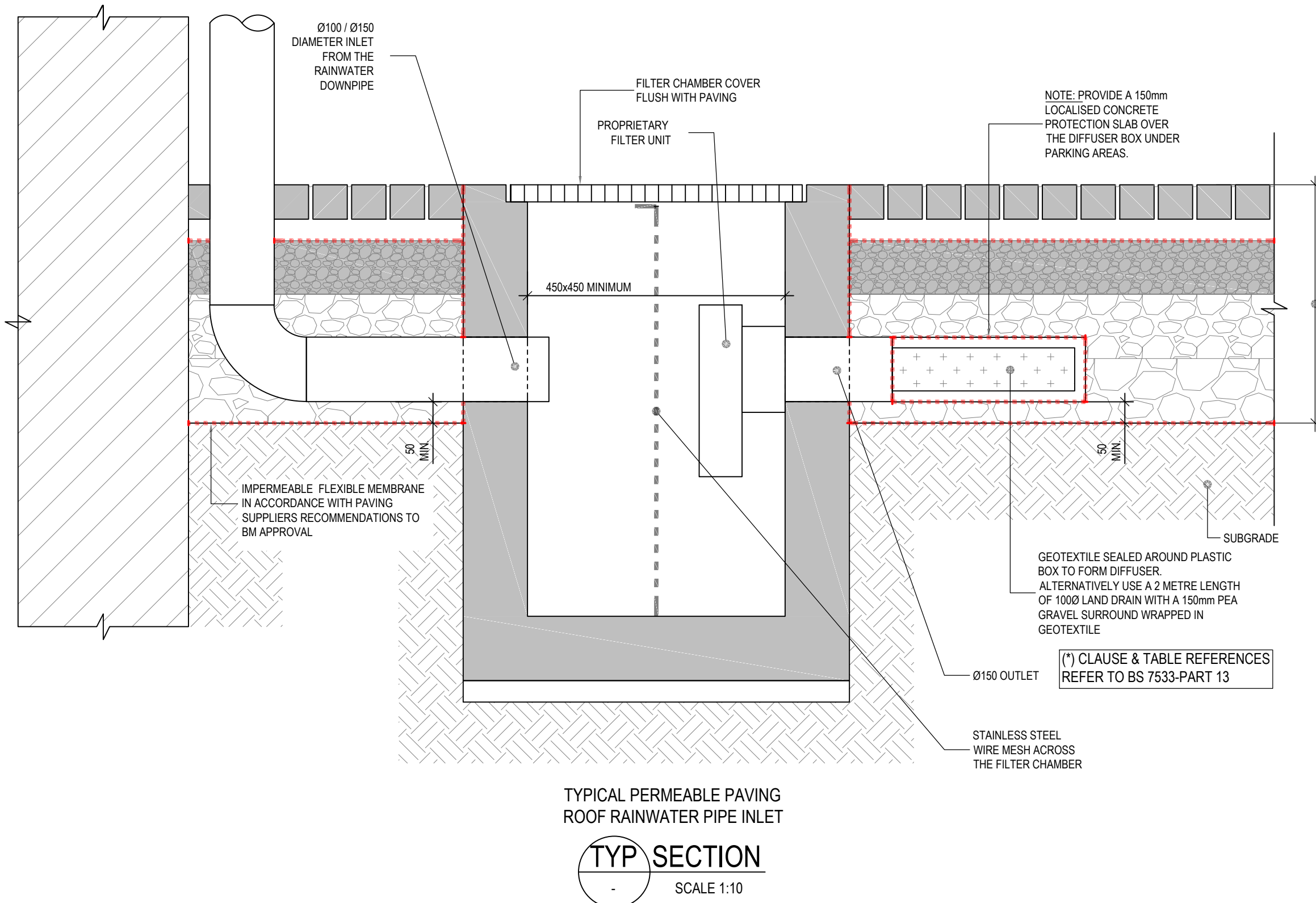
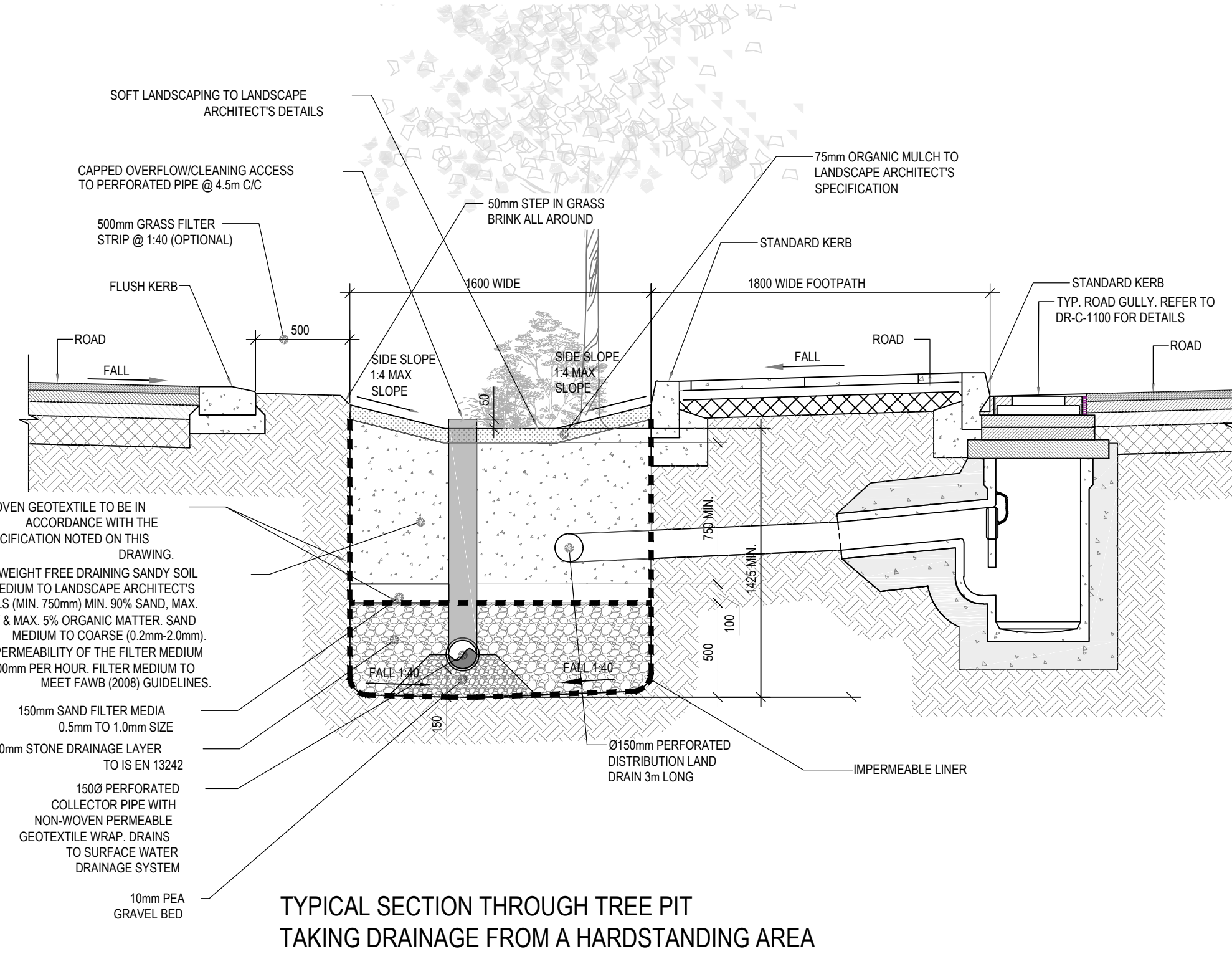
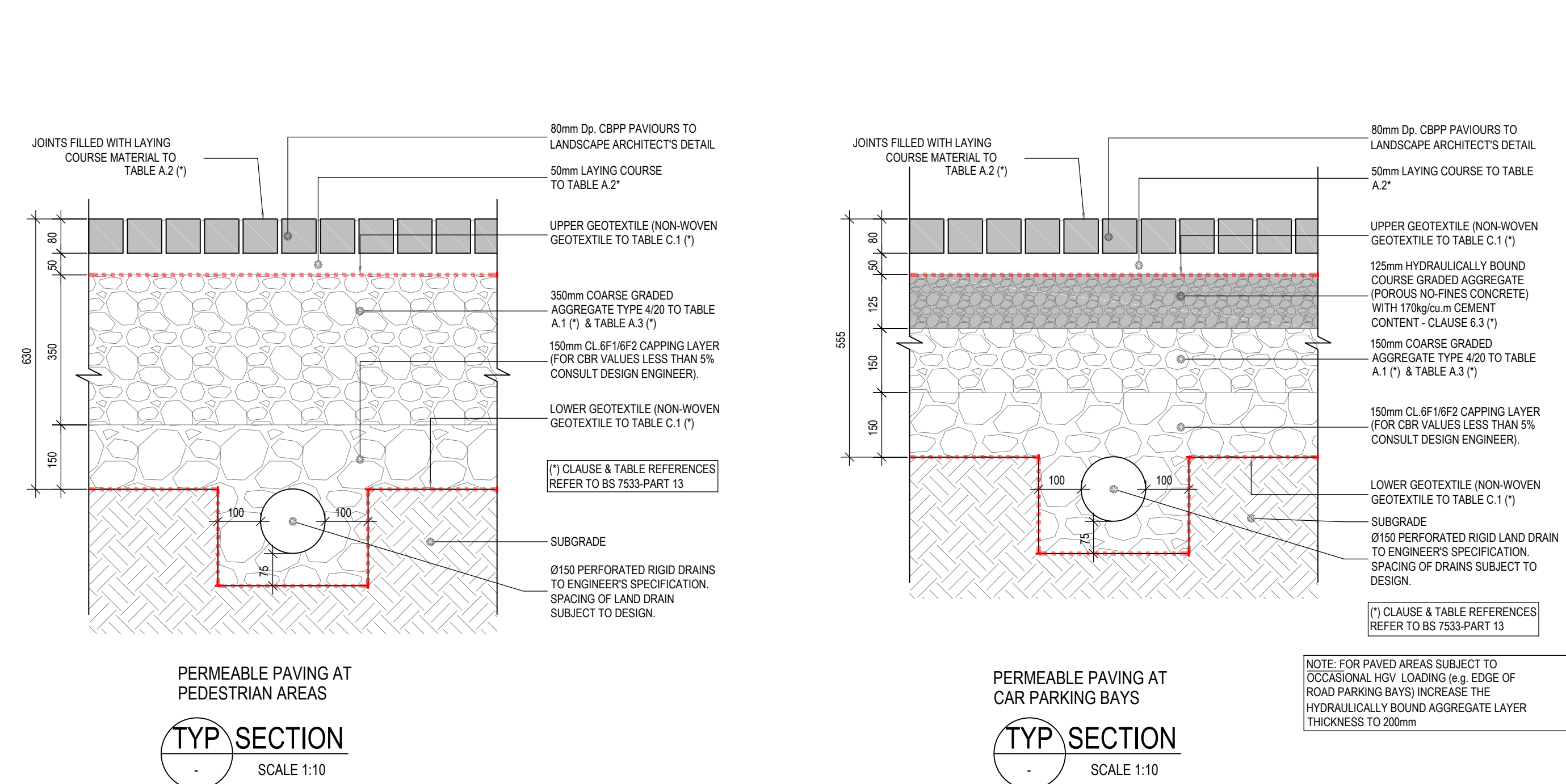

S2 P05	ISSUED FOR PLANNING	19.06.2024	RR	AL
S2 P04	DRAFT ISSUE	07.06.2024	RR	AL
S2 P03	ISSUED FOR PLANNING	28.05.2024	RR	AL
S2 P02	ISSUED FOR LRD OPINION	27.03.2024	NQ	AL
S2 P01	DRAFT ISSUE	14.03.2024	NQ	AL
Rev.	Note	Date	Drawn	Check

DONNACHADH O'BRIEN & ASSOCIATES CONSULTING ENGINEERS	UNIT 5G ELM HOUSE MILLERSNUTE PARK NAAS CO. KILDARE	PHONE: +353 45 984 012 INFO@DOBRIENENGINEERS.IE WWW.DOBRIENENGINEERS.IE
--	---	--

Client:	MARSHALL YARDS DEVELOPMENT COMPANY LTD.						
Project:	BALLYBIN ROAD LRD , RATOATH, CO. MEATH						
Drawing Title:	TYPICAL SuDS DETAILS						
Drawn By:	Checked By:	Approved By:	Date:	Scale:	Sheet Size:		
NQ	AL	DOB	MAR 2024	AS SHOWN	A0		
Project Number:	Drawing Number:			Status Code:	Rev Number:		
DOBA2334	2334-DOB-XX-SI-DR-C-0250			S2	P05		